

NOTES: UNLESS OTHERWISE SPECIFIED:

NOTES: UNLESS OTHERWISE SPECIFIED:

1. MATERIAL: 6061-T6 ALUMINUM
2. LIGHT BEADBLAST EXTERIOR SURFACES ONLY (MATTE FINISH)
3. FINISH: ANOPLATE ANOBLACK EC PROCESS. ALTERNATE BLACK ANODIZING PROCESSES NOT CONSIDERED AN EQUIVALENT

© COPYRIGHT 2013 TEXAS INSTRUMENTS
UNPUBLISHED, ALL RIGHTS RESERVED

REVISIONS

REV	DESCRIPTION	DATE	BY
A	ECO #2136196 - INITIAL RELEASE	9/20/13	RDR

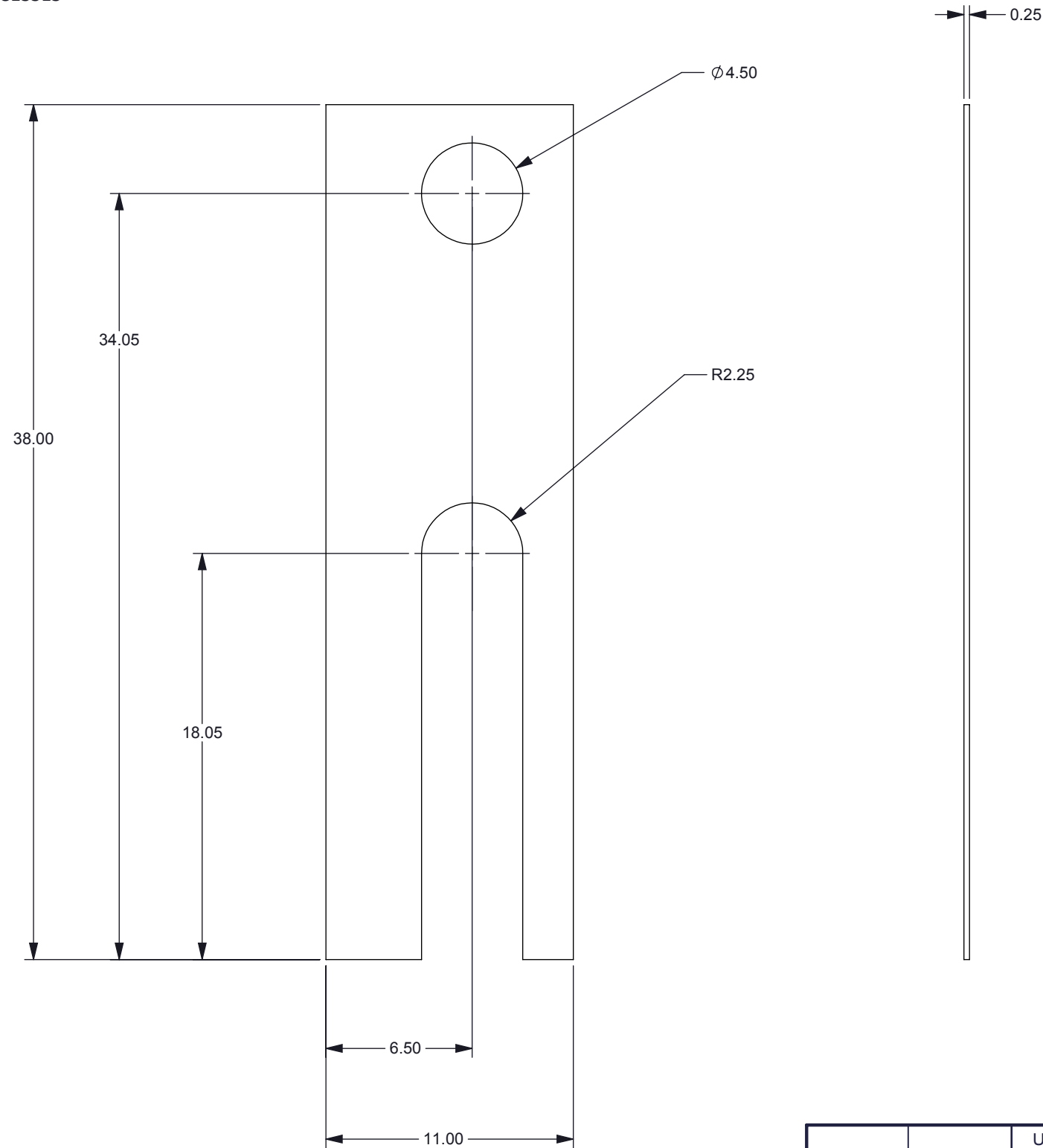

UNLESS OTHERWISE SPECIFIED

- DIMENSIONS ARE IN MILLIMETERS
- TOLERANCES: ANGLES $\pm 1^\circ$
2 PLACE DECIMALS ± 0.25
1 PLACE DECIMALS ± 0.50
- DIMENSIONAL LIMITS APPLY BEFORE PROCESSES
- INTERPRET DIMENSIONS IN ACCORDANCE WITH
ASME Y14.5M-1994
- REMOVE ALL BURRS AND SHARP EDGES
- PARENTHEThICAL INFO FOR REF ONLY

DWN
R ROWE
Engr

DATE
4/15/2013

CQE/QA

S	CM
---	----

Apprvd



TEXAS
INSTRUMENTS

SHIM, DETECTOR ADJUST, .25MM

SIZE	DWG NO
------	--------

	B
--	---

2513414

REV
A

SCALE 4:1

SHEET 1 OF 1